

# LVT-1600 & LVT-4000 Installation Instructions

## 1. VERY IMPORTANT!

Felt Pad must be attached on outside edge of Adapter "A". Position it to cover the outside circular portion that will be the hold for the Hook labeled "E" in step 5.

## Model LVT-4000

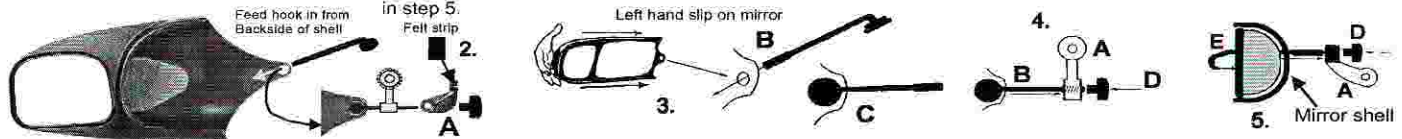

1. To begin installation, the (2) felt strips enclosed in kit, must be attached to adapters "A" for a secure fit.
2. To attach peel adhesive backing off and place felt strip on adapter (item A) as shown be sure to cover entire outer rim.
3. Next slip the Longview mirror over your vehicle mirror and insert hook (B) through the mirror shell hole from the back side, as shown, so that the disc is on the backside of mirror shell. Align hook as shown (C) it will be horizontal to the ground .
4. Slip adapter (A) over the threaded portion of hook (B) and twist on a knob (D) a few turns, do not completely tighten.
5. Insert hook (E) through the other hole in Adapter (A) and twist knob (D) on a few turns. While steadying the mirror pull Hook (E) towards the front of your vehicle mirror housing and clamp it onto the rim of your vehicle mirror housing.
6. While steadying the towing mirror in position, tighten both knobs (D) simultaneously onto hooks (B) and (E) until the towing mirror is secure and does not move. You are now ready to adjust the mirror glass for optimal view.

**DO NOT OVER TIGHTEN!**

To view a video of the assembly visit our web site at [www.LongviewTM.com](http://www.LongviewTM.com)